

The "Handy" One Handed Pepper Grinder Kit

KIT FEATURES:

- Stainless Steel components
- Reliable, one handed grinding function
- Simple refill feature for peppercorns
- Easy to turn with single internal hole
- Overall Length: 6"

REQUIRED ACCESSORIES:

- Mandrel Jam Chuck System: #PKMJAM -includes jam chucks for both ends (Requires lathe with #2 Morse Taper)
- 60° Live Tailstock Center: #LCENTLTx or Mandrel Saver #PKMSTS2
- 1" Forstner Bit: #FB1
- Forstner Bit Extension: #FEX
- 2 Part Epoxy Glue
- Blank Minimum Size: 1-1/2"x1-1/2"x3-13/16"

Optional accessories:

- Lathe chuck equipped with jaws closing smaller than 1/4"
- 1" Jam Chuck: #CJAM1 or shop made jam chuck
- Large Blank Lathe Drilling Chuck: #CSCPENCHK2



DIAGRAM A / PARTS LAYOUT

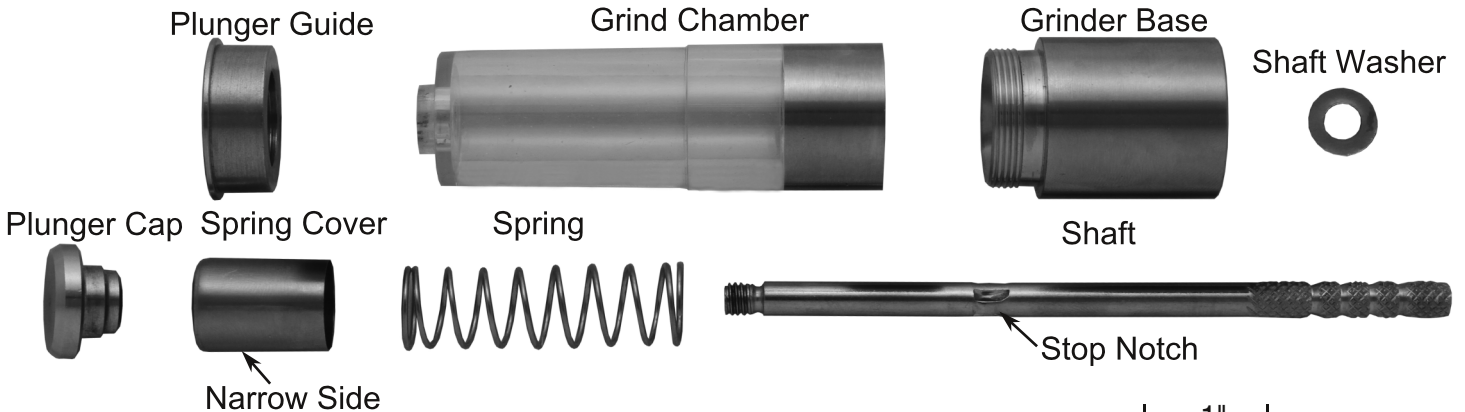

PREPARING THE BLANK:

- Cut a single blank 3-13/16" long
- Install the 1" Forstner bit in the Bit extension. This will allow you to bore through the entire length of the blank.
- Drill a 1" hole lengthwise through the center.

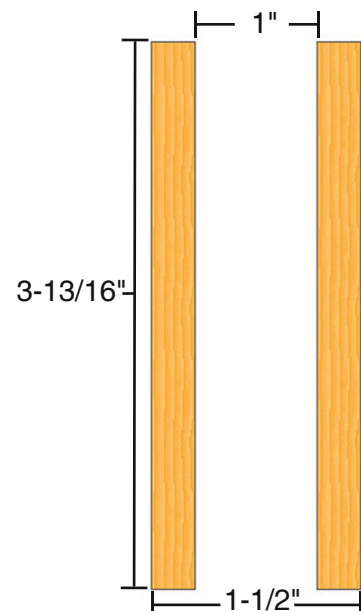
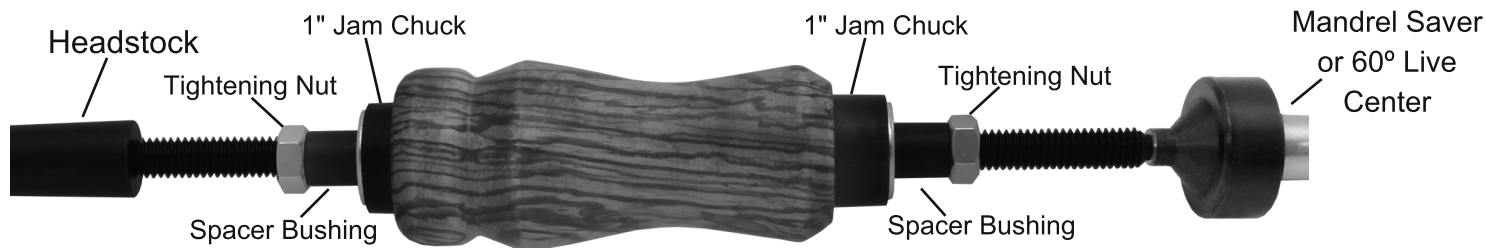

DIAGRAM B / PKMJAM Setup Consult Instruction included with Mandrel**DIAGRAM C / CJAM1 Setup** See Instructions Below**TURNING THE BLANK:**

- Mount your chuck onto the head stock of your lathe.
- Install 60° live center in tailstock.
- Insert 1" Jam Chuck into the chuck and tighten the chuck jaws. Leave enough room to access the nut the shaft of the jam chuck.
- Slide blank onto Jam Chuck and slide tailstock so that the tailstock center is inside the blank.
- Hold the chuck steady and tighten the nut on the Jam Chuck until it starts to grip the inside of the blank.
- Advance the Tailstock until the blank aligns itself onto the tailstock center and finish tightening the Jam Chuck until it firmly grips the blank.
- Lock Tailstock and advance the quill until the blank is firmly held. Do not to overtighten as it can split the blank.
- Turn the blank to the profile of your choice. Make sure ends are straight to help ensure an even fit with parts.
- If you wish to turn the profile to match the grinder parts, The ends should be turned down to 1.08" (Use digital calipers to check sizing).
- Sand the blank, gradually increasing sandpaper grits.
- Finish the barrel using your choice of polish. Allow sufficient time for the polish to cure—refer to polish instructions.

ASSEMBLY:

- Arrange parts according to Diagram A. To ensure smooth action and avoid misalignment, parts must be fully assembled during gluing.
- Place Shaft Washer over threaded side of Shaft - slide down to Stop Notch.
- Insert Shaft, threaded side first, through the bottom of the Grind Chamber. Push up until it cannot go further.
- Thread Grinder Base into Grind Chamber.
- Insert Spring into the wider end of Spring Cover. It should stay in place.
- Insert Plunger Cap into Narrower side of Spring Cover and into Spring opening. It should stay in place.
- Mix a small amount of epoxy and apply inside both ends of the the Barrel. Be careful not to get epoxy outside the hole.
- Slide the Grind Chamber into the lower opening, twisting to spread epoxy evenly. Insert until Grinder Base is fully against Barrel.
- Slide the Plunger Guide into the upper opening, twisting slightly to spread epoxy evenly.
- Insert assembled Plunger, spring side first, into Plunger Guide. You may have to push to reach Shaft and thread it on. Hold the Shaft on other side to help with tightening.
- Set aside the glued barrel and allow the epoxy to cure.
- To add peppercorns, unscrew Base from Grinder. When full, re-install Base as described above.