

# The Compson Pen Kit

PKJPENCH • PKJPENGT • PKPKJPENBT

## Kit Features:

- Improved, Trouble free click mechanism.
- Uses Parker® style refill.
- Overall length: 5-1/4"
- Easy to turn and assemble. Single tube design.

## Required Accessories:

- 7mm, pen mandrel.
- 3/8" Drill bit #PKEEXEC-3/8"
- 2 pc. bushing set #PKJPENBU
- Universal barrel trimming set #PKTRIMKIT (use 3/8" shaft)
- 2 Part epoxy glue or, insta-cure (cyanoacrylate) glue
- Live Center



DIAGRAM A / PARTS LAYOUT

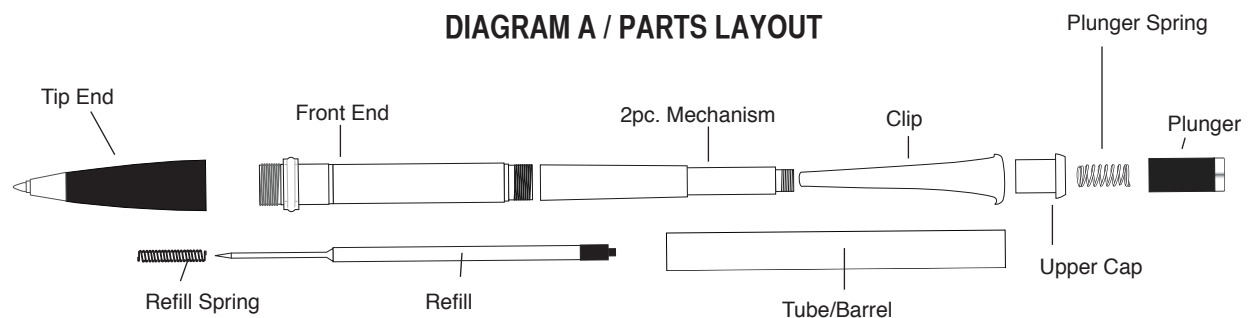

## Preparing the Blanks:

- Cut a 5/8" blank to the size of the brass tube (add 1/16" for trimming the ends).
- Drill a 3/8" center hole lengthwise through the blank.
- Spread glue over the tube, insert into the blank with a twisting motion, to spread the glue evenly inside, center the tube in the blank
- When the glue dries, use a 7mm barrel trimmer to square the ends of the blank. Take the wood down to the brass tube. Do not over trim or leave excess glue inside the tube since this may cause problems with the mechanism function.

## DIAGRAM B / TURNING THE BLANKS

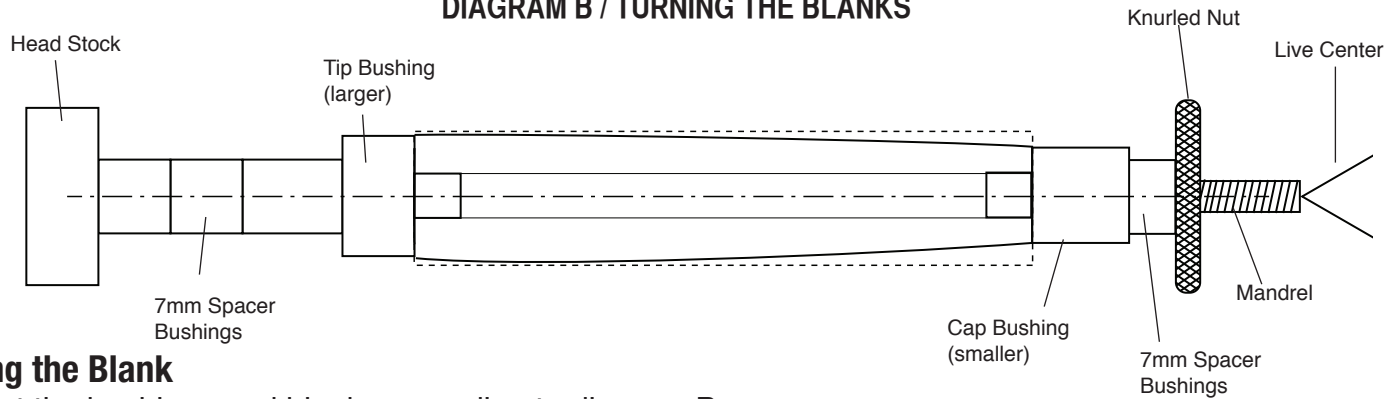
**Turning the Blank**

- Mount the bushings and blanks according to diagram B.
- Thread on the knurled nut and hand tighten to hold all components in place.
- Slide the tailstock up snugly against the mandrel shaft inserting the live center point into the mandrel dimple, lock in place.
- Hand tighten the quill adjustment to firm up the mandrel. (Do not overtighten, it could damage the mandrel).
- Using sharp tools, turn the blank down close to the bushing diameter. Turn the barrel (to a profile of your choice)
- Sand the blank down to be flush with the bushings gradually increasing the sandpaper grits.
- Finish the barrel with your choice of polish. Allow sufficient time for the polish to cure – refer to polish instructions.

**Assembly NOTE:** Layout parts according to diagram A

- Insert and screw in the 2 pc mechanism over the front end.
- Slide and press the wider end of the barrel over the front end.
- Insert the upper cap into the hole in the clip. Press this assembly into the opposite end (narrow) of the barrel.
- Place the refill spring on the refill tip and then insert the refill into the opening at the front (with tip end removed).
- Screw tip into front end of pen.
- Insert the plunger spring into the opening and then the plunger. Screw onto the mechanism inside.
- The pen is ready to operate by clicking on the plunger to extract or retract the refill tip.

**Diagram C / Bushings #PKJPENBU**